

**[Gen] Non-dissipative Elements Design**  
Improvement of design & speed

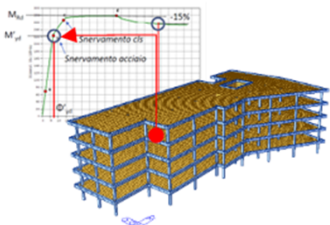

**[Gen] Pushover Analysis**  
Addition of new hinge curve as per EC8 : 2004



**[Gen] Irregularity Check**  
Addition of Irregularity reduction factors as per NSR-10

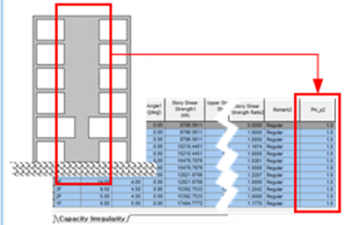

**[Gen] Wind Pressure**  
Input of wind pressure by editing table

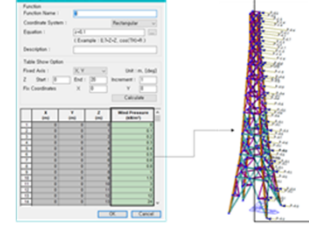

**[Gen] Rebar Information**  
Renewal of Rebar Information Dialog Box

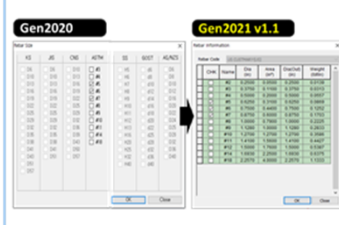

**[Gen] Seismic Shear Design**  
Improvement of reduction factor for Vc as per ACI318-14

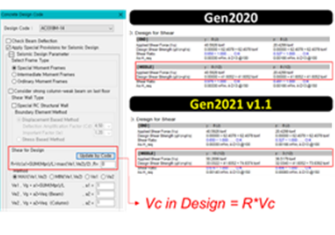

**[Gen] Static Earth Pressure**  
Addition of Static earth pressure of function type.

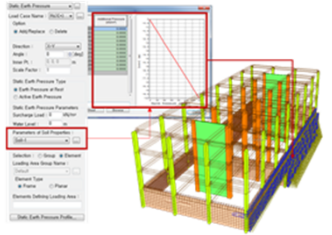

**[Gen] Gen2021-Revit2021 Link**  
Support of new version

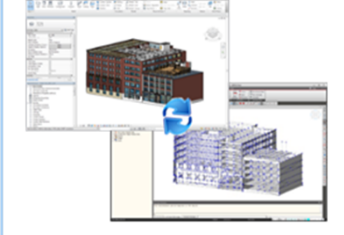

**[Design+] Combined Footing**  
Addition of combined footing design as per Eurocode 2: 04

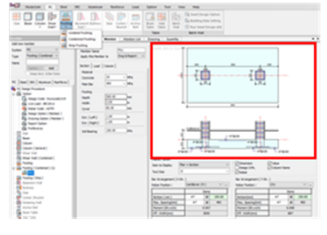

**[Gen & Design+]**  
Other improved features

